



CUT SHEET

TLS SOLA REPEATER TRX-320

DESCRIPTION

The TLS Sola repeater TRX-320 was designed to maintain the CCT and dimming levels across a TLS Sola system, receiving the control signal from the TMDX-320 Sola Master Controller or any 3rd party DMX device. Multiple repeaters can be daisy-chained to each other to create large scale TLS Sola systems.

FEATURES

- Accurately repeats the CCT and dimming levels
- Compatible with the TLS Sola master controller (TMDX-320) and any DMX input signal from 3rd party.
- Compact size
- Robust construction
- High current capacity



DIMENSIONS

Top view

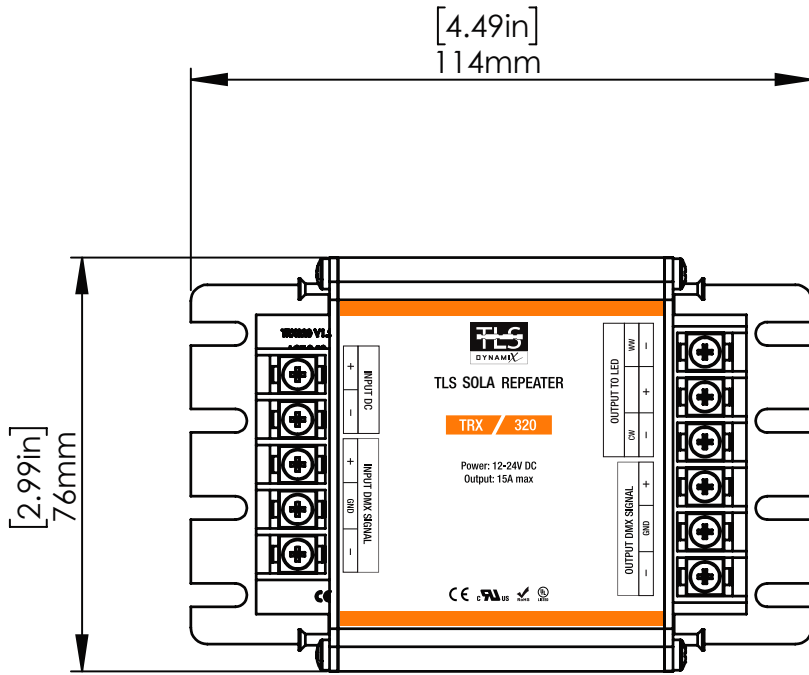

Side view

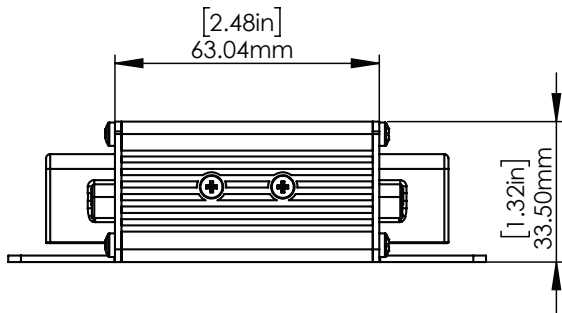

Front view

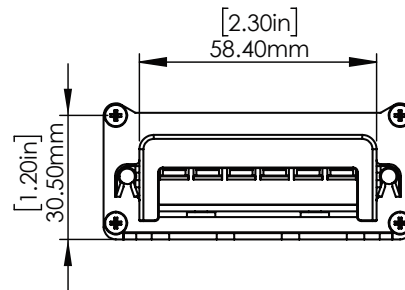

WIRING DIAGRAM REPEATER TRX-320 WITH 3rd party DMX signal

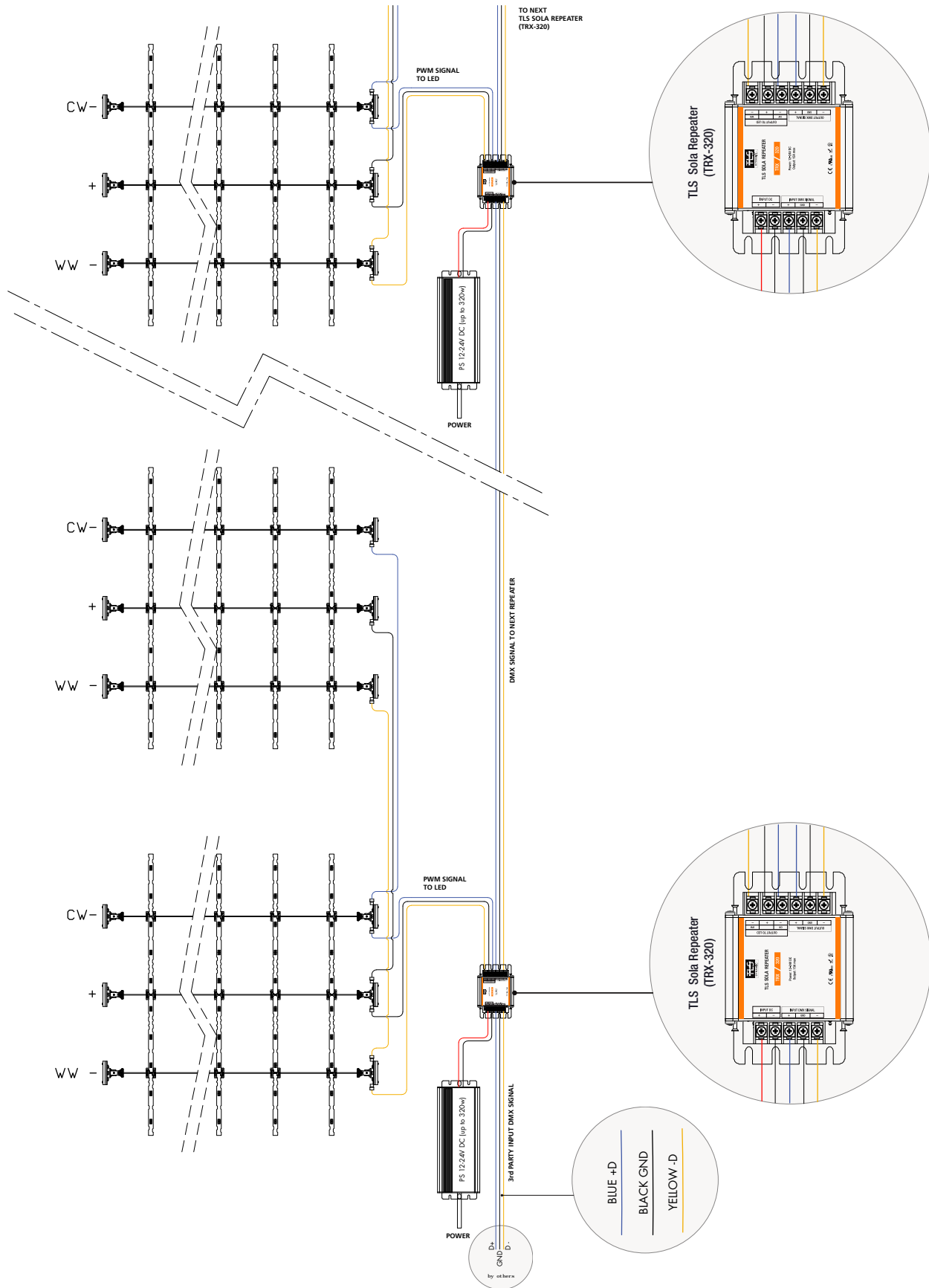

WIRING DIAGRAM TRX-320 WITH MASTER TMDX-320

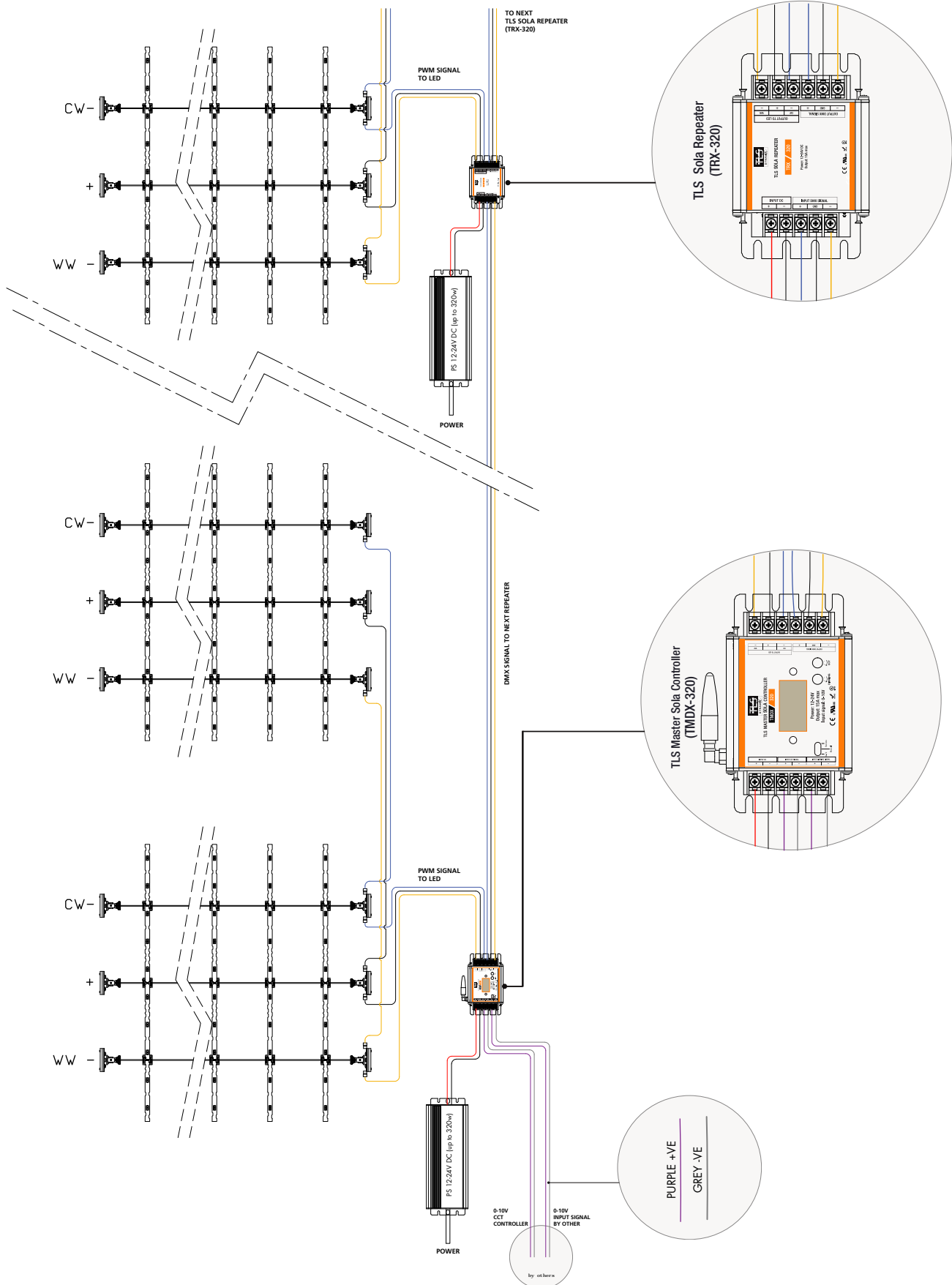

ACCESSORIES

TECHNICAL SPECIFICATIONS

ELECTRICAL

OPERATING VOLTAGE	12 - 24 V DC
OUTPUT CURRENT	Max 15 A
OUTPUT POWER	320W Max
OPERATING TEMPERATURE	-30 C to + 80 C
FLICKERING %	0 - 20%

CONTROL

INPUT SIGNAL	DMX
OUTPUT SIGNAL	PWM to LED & DMX signal to next TRX-320



RATING

INGRESS PROTECTION	IP22 (optional IP65)
--------------------	----------------------

PHYSICAL

DIMENSIONS	W 76mm, H 33.50mm, L 114mm
HOUSING	Clear anodized aluminium
WEIGHT	189 gr

CERTIFICATION

CERTIFICATION	   
---------------	--